

# END OF TERM 1 EXAMS

# AGRICULTURE

## FORM THREE

## PAPER 2

TIME: 2 HOURS

NAME..... ADM NO:.....

SIGN..... INDEX NO:.....

DATE;.....

### INSTRUCTIONS TO CANDIDATES:

- Answer *ALL* the questions
- Answers should be written in the spaces provided

### SECTION A ( 30MARKS)

1. Name **three** types of dairy goats reared in Kenya (1 ½)

.....  
.....  
.....  
.....

2. a). What is raddling in sheep management (1mk)

.....  
.....  
.....

b. Give **two** reasons for raddling in sheep management

(1mk)

.....  
.....  
.....

3. Give **three** advantages of contemporary comparison method in selection of livestock (1<sup>1/2</sup>)

.....  
.....  
.....  
.....

4. Give **two** reasons for spreading a polythene paper (pvc) on the slab of a permanent farm building (2mks)

.....  
.....  
.....

5. Name three types of Fresh warm water fish reared in Kenya

(1 ½ mks)

.....  
.....  
.....

6. a) Give **three** disadvantages of inbreeding in cattle production

(1<sup>1/2</sup>mks)

.....  
.....  
.....

b). Give **three** ad vantages of embryo transplant in cattle

(1<sup>1/2</sup>mks)

.....  
.....  
.....

7. Name the farm tools used for each of the following operations listed below.
- a) Tightening barbed wire during fencing.....(**1/2 mark**)
  - b) Smoothing of concrete floors.....(**1/2 mark**)
  - c) Giving liquid drugs to livestock through the mouth .....(**1/2 mark**)
  - d) Sharpening the teeth of across-cut saw.....(**1/2 mark**)

8. List **four** factors considered when making a choice of building materials. **(2 marks)**

.....

.....

.....

.....

.....

9. State **two** reasons why calves should be housed singly . **(1 mark)**

.....

.....

.....

10. What is cropping in fish farming? **(1/2 mark)**

.....

.....

.....

11. State **three** methods of disbudding young calves. **(1 1/2 marks)**

.....

.....

.....

12. State **two** reasons why calves should be housed singly . **(1 mark)**

.....

.....

.....

13. Name **one** intermediate hosts for each of the following.

a) Tapeworm(*Taenia spp*).....(½ mark)

b) Liver fluke(*Fasciola spp*).....(½ mark)

14. Name **four** disease predisposing factors outside an animal's body. **(2 marks)**

.....  
.....  
.....  
.....  
.....

15. State **four** factors that determine the amount of water a beef animal can take . **(2 marks)**

.....  
.....  
.....  
.....  
.....

16. State **four** structural requirements of a zero grazing unit. **(2 marks)**

.....  
.....  
.....  
.....  
.....

17. a) Name the tool used for shearing wool sheep. ....(½ marks)

b) State **three** practices carried out during tuppig season in sheep management. **(1½ marks)**

.....  
.....

18. State **three** functions of carbohydrates in livestock nutrition.

(1½ marks)

.....

.....

.....

.....

.....

**SECTION B 20 MARKS**

19. Below are illustrations of farm tools and equipment.



A

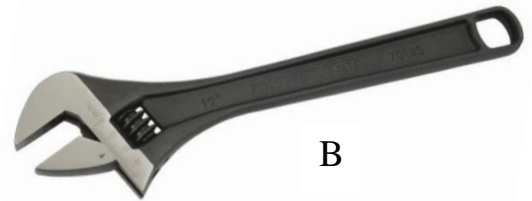

B



C

a) Identify the tool labelled A and C

(1 mark)

A

B

(1 mark)

b) State the advantage of tool B over tool C

(1 mark)

c) State two maintenance practices carried out on tool labelled B.

(2 marks)

20. Below is a farm structure. Study it carefully and answer the questions that follow.

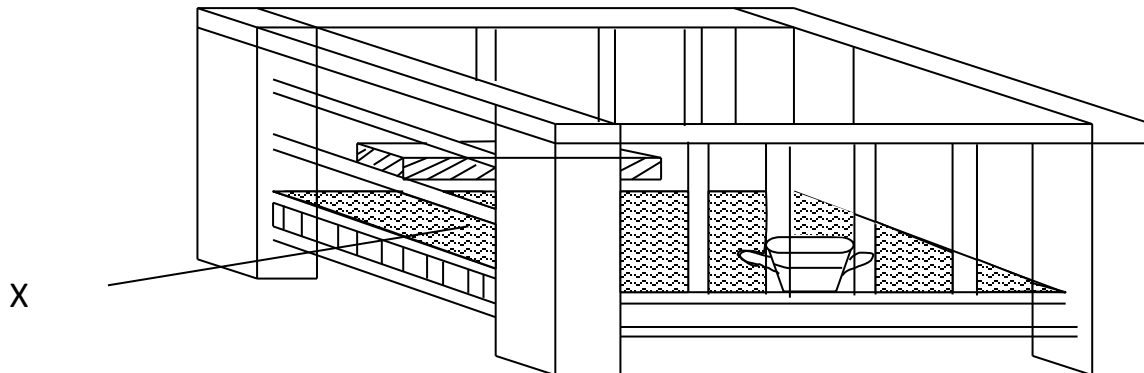

a) Identify the farm structure above .....(1 mark)

b) State the requirement of the part labelled X (1 mark)

.....  
.....

c) State **three** maintenance practices that should be carried on the structure. (3 marks)

.....  
.....  
.....

21. A dairy farmer prepared 1000kg of feed (20%DCP) from the following feedstuffs:

Oats – 10% DCP , Simsim seedcake 60% DCP

Calculate the amount of each feedstuff used using Pearson’s square method. (3marks)

b) Classify the following feedstuffs as either roughage or concentrate. (2marks)

i) Bone meal \_\_\_\_\_

ii) Silage \_\_\_\_\_

22. Study the diagram below of a farm structure and answer the questions that follow.

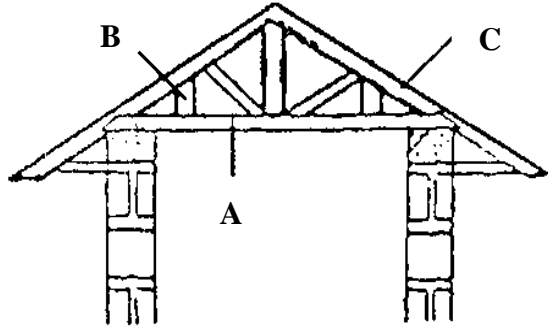

a) Identify the parts labelled A, B, and C. (3 marks)

A \_\_\_\_\_

**B**

---

**C**

---

- b) Name **two** chemical preservatives that can be used to treat the wooden part of the above structure against fungi and insect attack. **(2marks)**

.....

.....

.....

.....

**SECTION C 40 MARKS**

**Answer any two questions from this section in the spaces provided .**

23. [a] Describe six signs of farrowing in a sow . [6mks.]
- [b] Explain six benefits of the Kenya top bar hive . [6mks.]
- [c] Explain eight factors considered when siting farm structures . [8mks.]
- 
24. a) State and explain 5 reasons for keeping livestock. (10 marks)
- b) Describe factors considered when selecting a gilt for breeding. (6 marks)
- c) Name four systems of breeding used to improve livestock. (4 marks)
- 
25. a) Describe ten general methods of disease control in livestock. (10marks)
- b) Describe the advantages of fences. (10 marks)